



## QUICK START GUIDE

# BAR 9.1 TRUE WIRELESS SURROUND WITH DOLBY ATMOS®





**EN** Before using this product, read the safety sheet carefully.

**ZH-CN** 使用本产品前, 请仔细阅读安全说明书。

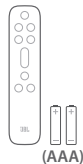

**EN** \*Power cord quantity and plug type vary by regions. \*\* For some regions only.

**ZH-CN** \*电源线数量和插头类型因区域而异。\*\* 仅适用于部分地区。

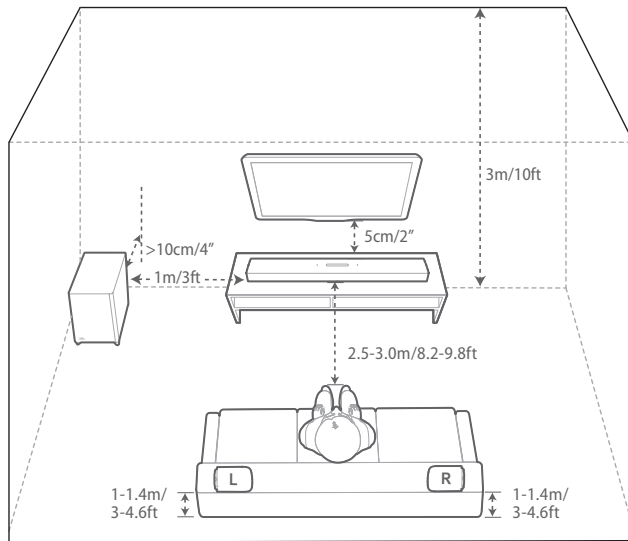



(A)

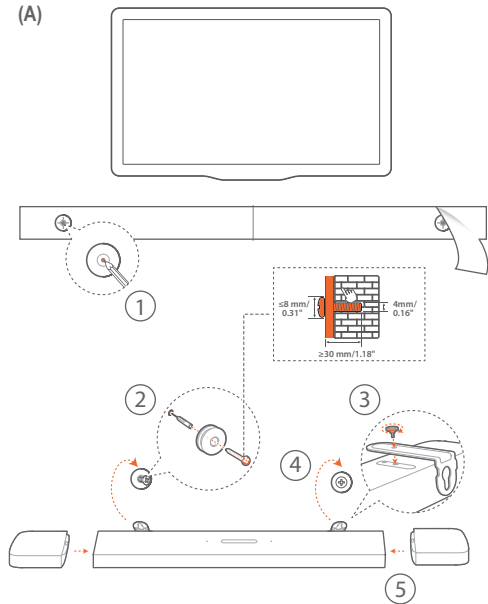

(B)

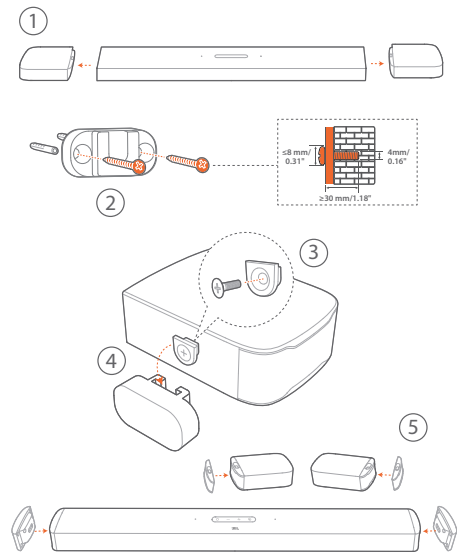



**EN**

To move the soundbar, first remove the two detachable speakers to avoid accidental damage.

**ZH-CN**

移动本条形音箱时，请先取下两个可拆分扬声器以避免意外损坏。



## TV (HDMI ARC)

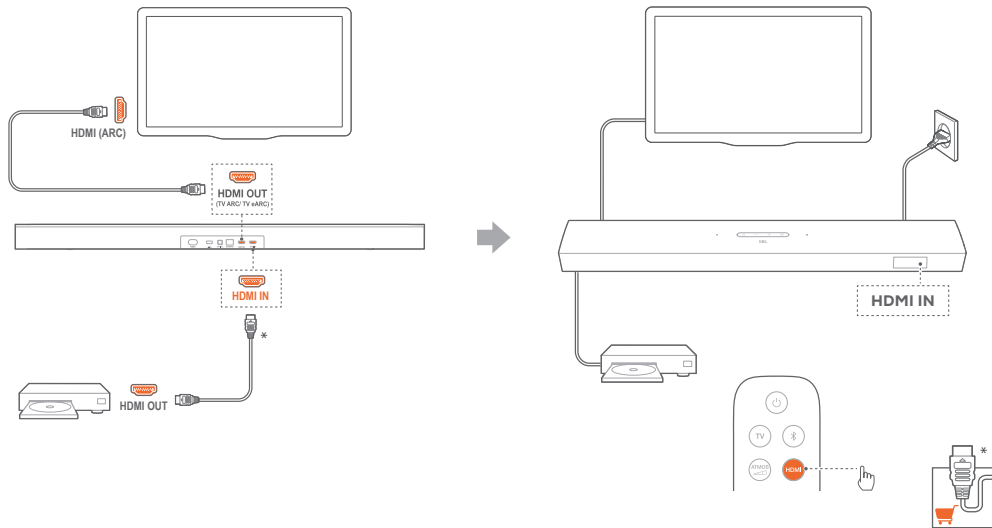



## TV (HDMI eARC)

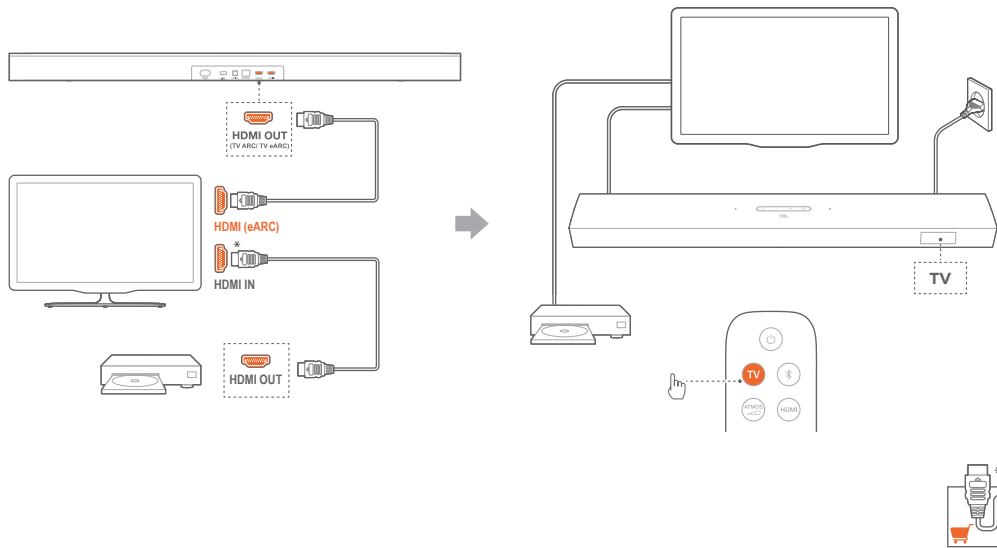

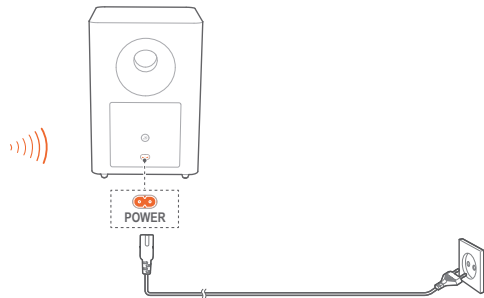
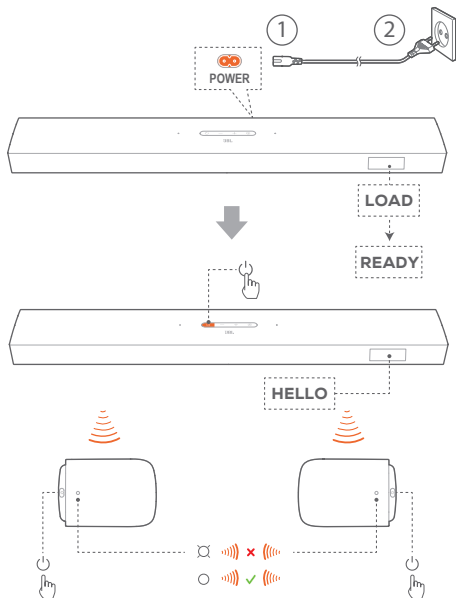

EN

The soundbar will pair with the two detachable speakers and the subwoofer automatically when they are powered on.

ZH-CN

当本条形音箱、可拆分扬声器以及低音扬声器均为开机状态时，本条形音箱会自动完成与可拆分扬声器及低音扬声器的配对。



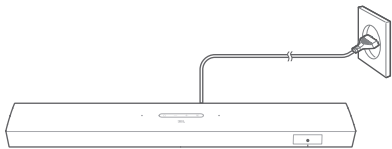

CHARGE SPKR. BATT LOW

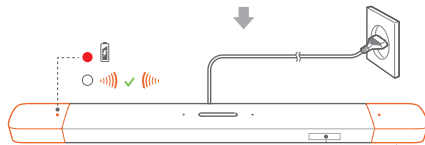
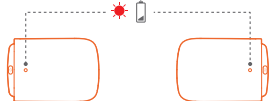

STDBY

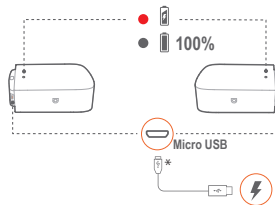
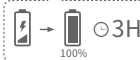

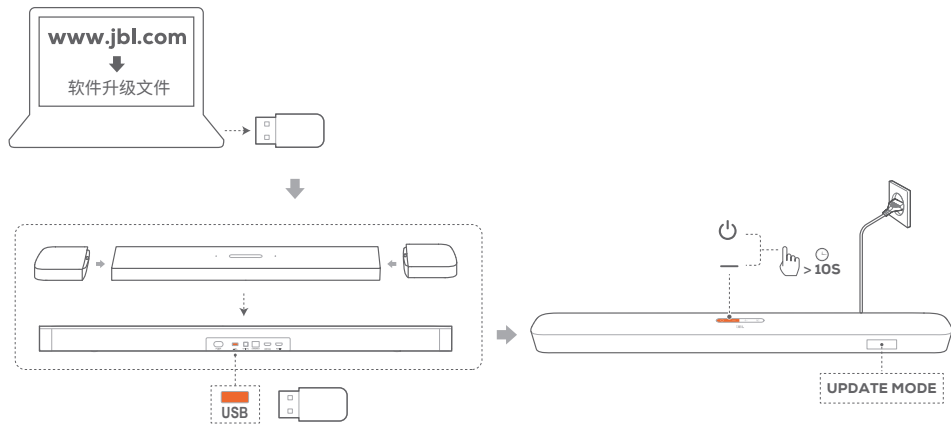

**EN** For software upgrade.

**ZH-CN** 用于软件升级。



①

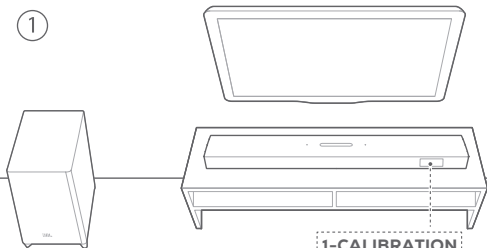

1-CALIBRATION:

1-DONE:

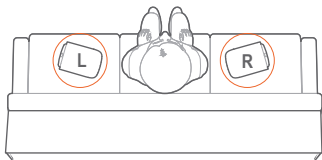

②

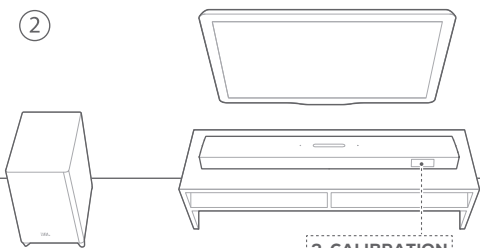

2-CALIBRATION:

2-DONE:



# DOLBY ATMOS® / DTS:X®

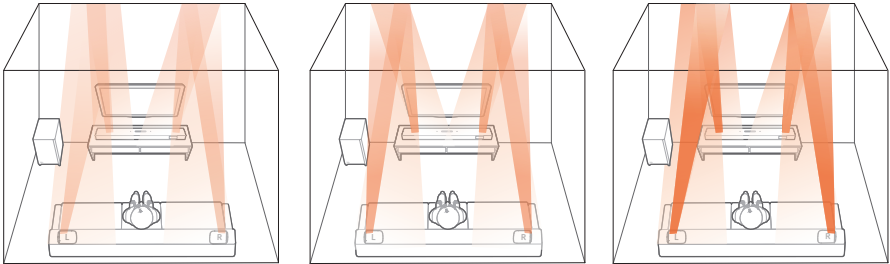

LOW

MID

HIGH



# REAR

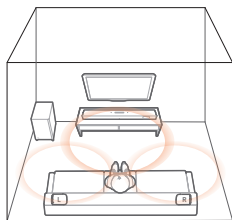

LOW

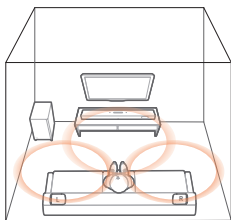

MID

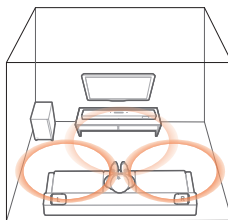

HIGH

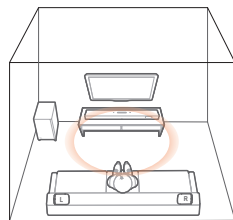

MUTED REAR SPKR

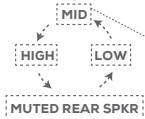

X 1



> 3S

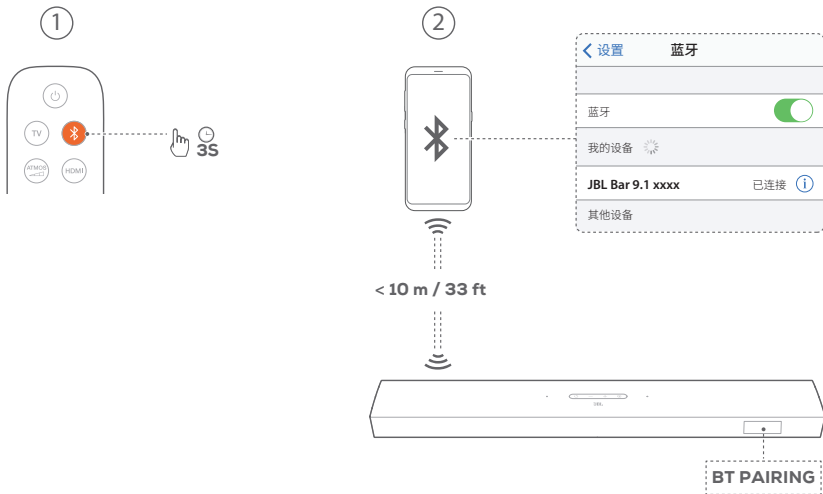



## QPLAY



EN



**Add the soundbar to your home Wi-Fi network:** Launch the WeChat app  on your mobile phone and then scan the above QR code, or search for the Mini Program "JBL家用音响设置". Follow the onscreen instructions to complete setup.

ZH-CN

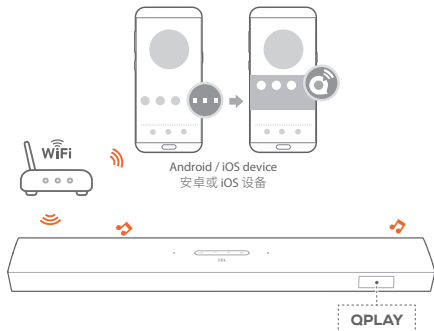
**将条形音箱接入您的家庭无线网络:** 在手机上开启微信 , 然后扫描二维码或搜索小程序“JBL家用音响设置”。按照屏幕提示完成设置。



EN

**Stream music from QQMusic to the soundbar:** Launch the QQMusic app  on your mobile phone, and start music playback. On the player screen, tap ... and then the QPlay icon  on the pop-up screen to select "JBL Bar 9.1 xxxx" as speaker.

ZH-CN

**通过QQ音乐将音乐播放传输至条形音箱:** 在手机上开启QQ音乐 , 开启音乐曲目播放。在播放屏幕, 点击..., 然后在弹出界面中点击 QPlay 图标  选择“JBL Bar 9.1 xxxx”为播放扬声器。



## AirPlay (iOS)

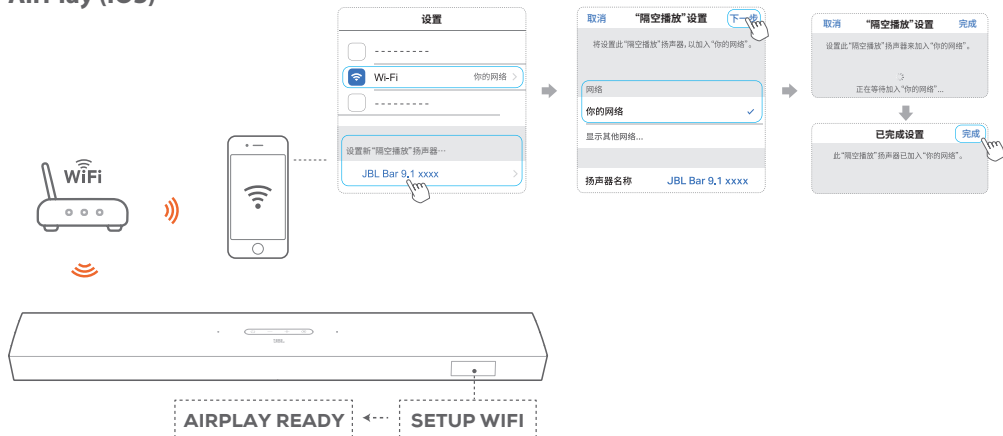

EN

For AirPlay only users, skip the WeChat Mini Program "JBL家用音响设置". On an iOS device, add the soundbar to your home Wi-Fi network through the AirPlay speaker setup. Follow the onscreen instructions to complete setup.

ZH-CN

对于仅使用AirPlay的用户，无需安装微信小程序“JBL家用音响设置”。在iOS设备上，选择设置 > Wi-Fi，在设置新“隔空播放”扬声器下选择“JBL Bar 9.1 xxxxx”。按屏幕提示完成设置。





## AirPlay

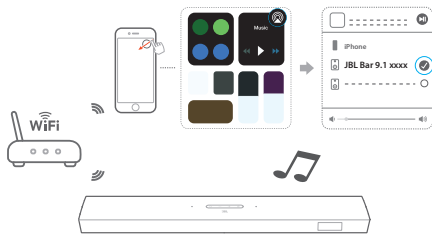

EN

To play music through AirPlay:

1. On an iOS device, enter the Control Center.
2. Tap to select "JBL Bar 9.1 xxxx" as speaker.
3. Start audio streaming from an app.

ZH-CN

通过AirPlay播放音乐时:

1. 在iOS设备上, 打开控制中心;
2. 点击 选择“JBL Bar 9.1 xxxx”作为扬声器;
3. 在App中开启音乐播放。

EN

### General specification:

- Model: BAR 9.1 CNTR (soundbar unit)  
BAR 9.1 SURROUND (detachable speaker)  
BAR 9.1 SUB (subwoofer unit)
- Sound system: 5.1.4 channel
- Power supply: 100 - 240 V AC, ~ 50/60 Hz
- Lithium battery: 3.635V, 3283mAh
- Total speaker power output (Max. @THD 1%): 820 W
- Soundbar output power (Max. @THD 1%): 400 W
- Surround speaker output power (Max. @THD 1%): 2 x 60 W
- Subwoofer output power (Max. @THD 1%): 300 W
- Soundbar transducer: 4xracetrack drivers + 2x up-firing full-range drivers + 3x 0.75" (20 mm) tweeter
- Surround transducer (per piece): up-firing full-range drivers + 0.75" (20 mm) tweeter
- Subwoofer transducer: 10"
- Operating temperature: 0°C - 45°C

### HDMI specification:

- HDMI Video input: 1
- HDMI Video output (with enhanced Audio Return Channel, eARC): 1
- HDMI HDCP version: 2.3

### Audio specification:

- Frequency response: 34Hz - 20KHz
- Audio inputs: 1 Optical, Bluetooth, USB (USB playback is available in US version. For other versions, USB is for service only.)

### USB specification:

- USB port: Type A
- USB rating: 5 V = 500 mA
- Supported file format: MP3
- MP3 codec: MPEG-1 Layer 2/3, MPEG-2 Layer 3, MPEG-2.5 Layer 3
- MP3 sampling rate: 16 KHz - 48 KHz
- MP3 bitrate: 80 kbps - 320 kbps

### Wireless specification:

- Bluetooth version: 4.2
- Bluetooth profile: A2DP V1.2, AVRCP V1.5
- Bluetooth frequency range: 2402 MHz - 2480 MHz
- Bluetooth Max. transmitting power: 13 dBm (EIRP)
- Modulation Type: GFSK, π/4 DQPSK, 8DPSK
- Wi-Fi network: IEEE 802.11 a/b/g/n/ac (2.4GHz/5GHz)
- 2.4G Wi-Fi frequency range: 2412 - 2472 MHz (2.4GHz ISM Band, USA 11 Channels, Europe and others 13 Channels)
- 2.4G Wi-Fi Max. transmitting power: 20 dBm (EIRP)
- Modulation Type: DBPSK, DQPSK, CCK, QPSK, BPSK, 16QAM, 64QAM
- 5G Wi-Fi frequency range: 5.15 - 5.35 GHz, 5.725 - 5.825 GHz
- 5G Wi-Fi Max. transmitting power: 22 dBm (EIRP)
- Modulation Type: QPSK, BPSK, 16QAM, 64QAM, 256QAM
- 5G wireless frequency range: 5180.0 - 5240.0 MHz, 5725.0 - 5825.0 MHz
- 5G wireless Max. transmitting power: 13 dBm (EIRP)
- Modulation Type: QPSK

### Dimensions:

- Dimensions (W x H x D): 884 x 62 x 120mm / 34.8 x 2.4 x 4.7 inches (soundbar); 173 x 60 x 120 mm / 6.8 x 2.4 x 4.7 inches (detachable surround speaker, per piece); 305 x 440 x 305mm / 12.0 x 17.3 x 12.0 inches (subwoofer)
- Weight: 3.64 kg / 8.0 lb (soundbar); 0.72 kg x 2 / 1.6 lb x2 (detachable surround speaker); 11.10 kg / 24.5 lb (subwoofer)
- Packaging dimensions (WxHxD): 1032 x 382 x 488 mm / 40.6 x 15 x 19.2 inches
- Packaging weight (Gross weight): 20 kg

## ZH-CN

### 一般规格:

- 型号: BAR 9.1 CNTR (主条形音箱)
- BAR 9.1 SURROUND (可拆卸环绕扬声器) BAR 9.1 SUB (低音扬声器)
- 音响系统: 5.1.4 声道
- 电源: 100 - 240 V AC, ~ 50/60 Hz
- 锂电池: 3.635 V, 3283 mAh
- 扬声器总输出功率 (THD为1% 时的最大值): 820 W
- 主条形音箱输出功率 (THD为1% 时的最大值): 400 W
- 环绕扬声器输出功率 (THD为1% 时的最大值): 2 x 60 W
- 低音扬声器输出功率 (THD为1% 时的最大值): 300 W
- 主条形音箱转换器: 4 个赛道驱动单元 + 2 个天空声道全频扬声器 + 3 个 0.75" (20 mm) 高音扬声器
- 环绕声转换器 (每个): 天空声道全频扬声器 + 0.75" (20 mm) 高音喇叭
- 低音扬声器转换器: 10"
- 工作温度: 0°C - 45°C

### HDMI规格:

- HDMI 视频输入: 1
- HDMI 视频输出 (带增强音频回传通道, eARC): 1
- HDMI HDCP 版本: 2.3

### 音频规格:

- 频率响应: 34Hz - 20kHz
- 音频输入: 1个光纤接口、蓝牙、USB (仅用于服务)

### USB 规格:

- USB 接口: A型
- USB 额定值: 5 V  $\overline{\text{m}}$  500 mA

### 无线规格:

- 蓝牙版本: 4.2
- 蓝牙配置文件: A2DP V1.2, AVRCP V1.5

- 蓝牙频率范围: 2402 MHz - 2480 MHz
- 蓝牙最大传输功率: 13 dBm (EIRP)
- 调制类型: GFSK,  $\pi/4$  DQPSK, 8DPSK
- Wi-Fi 网络: IEEE 802.11 a/b/g/n/ac (2.4GHz/5GHz)
- 2.4G Wi-Fi 频率范围: 2412 - 2472 MHz (2.4GHz ISM 频段、美国11个频道、欧洲和其它国家和地区13个频道)
- 2.4G Wi-Fi 最大传输功率: 20 dBm (EIRP)
- 调制类型: DBPSK, DQPSK、CCK、QPSK, BPSK, 16QAM, 64QAM
- 5G Wi-Fi 频率范围: 5.15 - 5.35 GHz, 5.725 - 5.825 GHz
- 5G Wi-Fi 最大传输功率: 22 dBm (EIRP)
- 调制类型: QPSK, BPSK, 16QAM, 64QAM, 256QAM
- 5G 无线频率范围: 5180.0 - 5240.0 MHz, 5725.0 - 5825.0 MHz
- 5G 最大传输功率: 13 dBm (EIRP)
- 调制类型: QPSK

### 尺寸:

- 尺寸 (宽 x 高 x 厚): 894 x 62 x 120mm / 34.8 x 2.4 x 4.7英寸 (主条形音箱); 173 x 60 x 120 mm / 6.8 x 2.4 x 4.7英寸 (可拆卸环绕扬声器, 每个); 305 x 440 x 305mm / 12.0 x 17.3 x 12.0英寸 (低音扬声器)
- 重量: 3.64 kg / 8.0 lb (主条形音箱); 0.72 kg x 2 / 1.6 lb x 2 (可拆卸环绕扬声器); 11.10 kg / 24.5 lb (低音扬声器)
- 包装尺寸 (宽 x 高 x 厚): 1032 x 382 x 488 mm
- 包装重量 (毛重): 20 kg

This product contains open source software licensed under GPL. For your convenience, the source code and relevant build instruction are also available at [https://harman-webpages.s3.amazonaws.com/jbl\\_9.1\\_3D\\_Surround\\_package\\_license\\_list.htm](https://harman-webpages.s3.amazonaws.com/jbl_9.1_3D_Surround_package_license_list.htm). Please feel free to contact us at:

Harman Deutschland GmbH

ATT: Open Source, Gregor Krapf-Gunther, Parking 3

85748 Garching bei Munchen, Germany

or [OpenSourceSupport@Harman.com](mailto:OpenSourceSupport@Harman.com) if you have additional question regarding the open source software in the product.



The Bluetooth® word mark and logos are registered trademarks owned by Bluetooth SIG, Inc. and any use of such marks by HARMAN International Industries, Incorporated is under license. Other trademarks and trade names are those of their respective owners.



The terms HDMI, HDMI High-Definition Multimedia Interface, and the HDMI Logo are trademarks or registered trademarks of HDMI Licensing Administrator, Inc.



The Wi-Fi CERTIFIED™ Logo is a certification mark of the Wi-Fi Alliance®.



Apple, AirPlay, iPad, iPad Air, iPad Pro, and iPhone are trademarks of Apple Inc., registered in the U.S. and other countries.

Use of the Works with Apple badge means that an accessory has been designed to work specifically with the technology identified in the badge and has been certified by the developer to meet Apple performance standards.

To control this AirPlay 2-enabled speaker, iOS 11.4 or later is required.



Manufactured under license from Dolby Laboratories. Dolby, Dolby Atmos, Dolby Audio, Dolby Vision and the double-D symbol are trademarks of Dolby Laboratories.



For DTS patents, see <http://patents.dts.com>. Manufactured under license from DTS, Inc. DTS, the Symbol, DTS and the Symbol together, DTS:X, and the DTS:X logo are registered trademarks or trademarks of DTS, Inc. in the United States and/or other countries. © DTS, Inc. All Rights Reserved.

QQ 音乐是本音响的内容合作伙伴腾讯公司的商业标识或版权形象。

